



## Bentone B1 Classic

1,20–3,06 kg/h (14,2–36,3 kW)

### Oil Burner

- Energy saving and compatible with environmental requirements
- Quiet in operation and designed for easy maintenance
- Reliable and trouble free
- Designed and developed to meet the European standard EN 267.
- Fully closing air damper saves energy
- Electronic transformer ensures a safer start and operation
- Plug-in contacts facilitate the installation and service. Eurostecker integrated.

Type	Typ	Type	B1 Classic			
			B1R	B1RV	B1FU	B1FUV
Model	Modell	Modèle				
Capacity	Leistung	Débit	1,3-3,5		1,20-3,06	
			kW		14,2-36,3	
Motor	Motor	Moteur	230/50/110			
Control box	Ölfeuerungsautomat	Coffret de sécurité	LOA24			
Oil preheater	Ölvorwärmer	Réchauffeur		*		*
Fuel pump	Ölpumpe	Pompe à fuel	BFF41 L3			
Adjustable burner head	Verstellbare Mischeinrichtung	Tête de combustion réglable	*			
Gross weight	Gewicht, brutto	Poids brut	kg c		12	
Volume	Volumen	Volume	m <sup>3</sup> c		0,05	

\* standard

Available for 60 Hz on request/Für 60 Hz erhältlich auf Anforderung/Déponible pour les fréquences de 60 Hz sur demande.

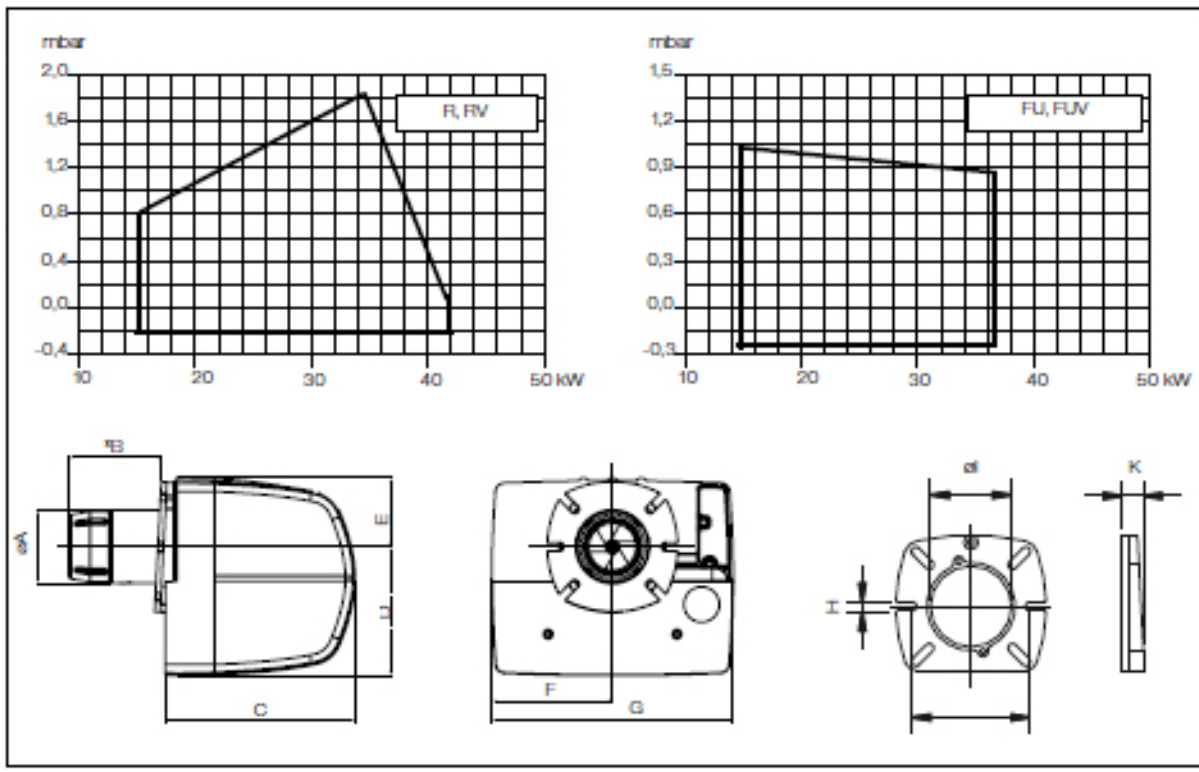

	ØA	B	C	D	E	F	G	H	ØI	J	K
B1 Classic	89	*	230	156	83	147	293	10,5	89,5	130-150	21

	B1R Classic	B1RV Classic	B1FU Classic	B1FV Classic
*Elast tube lengths mm	106	106	78	78
*Brennarohrlängen mm	156	156	108	108
*Longueur du tube diffuseur mm			158	158